

65: Stay, arm, joint, M56

V70 (00-08), 2001, D5244T, M56, L.H.D

12/11/2015

65: Stay, arm, joint, M56**PRINT****Bushing outer control arm upper, replacing****Special tools:**

951 2923
999 7030
999 7031
999 7035
999 7036
999 7038
999 7039
999 7054

Removal**Preparation**

Remove the wheel.

Disconnecting the lateral link

- Install the retaining strap and secure the lower control arm slightly against the jacking point
- Remove the lateral link screw at the spindle
- Slacken off the screw at the front mounting slightly. Turn the lateral link downwards.

**Disconnecting the control arms**

- Install tensioner and tension the rear suspension to the normal position. See Tensioner, instructions for use
- Remove the screw for the lower outer and upper control arm mounting.

Disconnecting the tie rod

- Remove the tie rod outer mounting
- Turn the tie rod upwards.

Removing the brake caliper

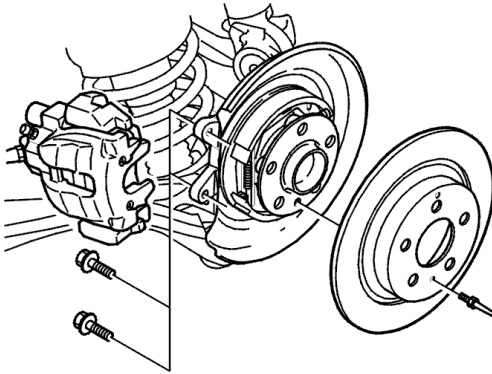

Release the parking brake adjuster. See Handbrake, brake shoes, replacing: Release the handbrake adjuster .

Remove:

- the ABS sensor and the ABS line from the bracket on the wheel spindle
- the brake caliper mounting screws.

Hang up the ABS line and the brake caliper. Use a piece of wire.

Removing the brake cable for the parking brake

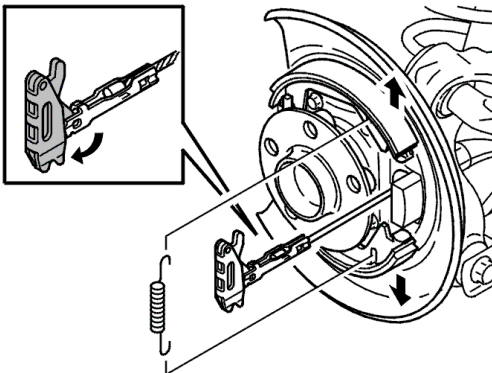

Remove:

- the locating pin for the brake disc
- the brake disc
- the return spring at the expander
- the expander. Lift the brake shoe slightly. Grip the expander. Pull the expander outwards.

Unhook the expander from the metal bracket.

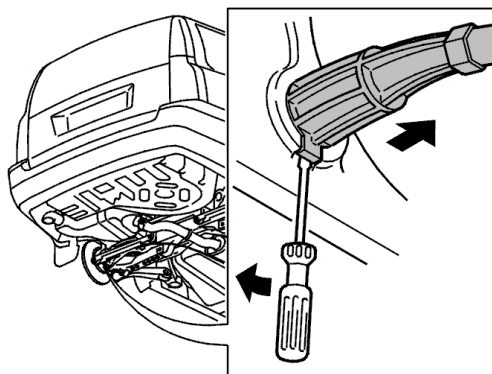

Remove:

- the guide sleeve for the cable sleeve. Apply a screwdriver between the guide sleeve lug and wheel arch. Pry apart slightly to remove the sleeve.

Removing the wheel spindle

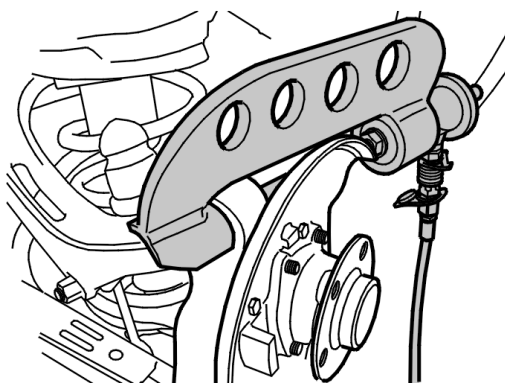

- Use tool 951 2923 with 999 7054 , 999 7031 , 999 7030 together with threaded rod 999 7039
- Press off the wheel spindle.

Note! Only press until the bushing releases from the splined joint.

Removing the bushing

- Install the hydraulic cylinder
- Use tool 951 2923 with 999 7054 , 999 7035 , 999 7036 and 999 7039
- Pull the bushing out.

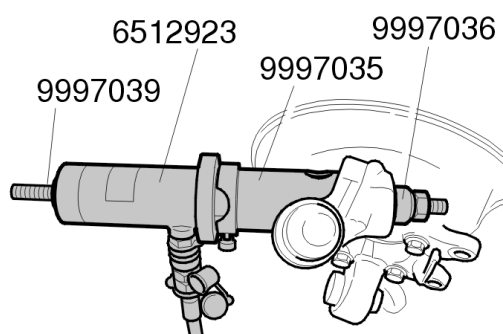

Installation

Installing the bushing

Note! To ensure that there is no exhaust leakage, see: Flanged joint, assembling .

- Install the hydraulic cylinder
- Use tool 951 2923 with 999 7054 , 999 7035 , 999 7036 , 999 7038 and 999 7039
- Pull the bushing.

Note! If necessary, tighten the nut on the tool after pressing approximately halfway.

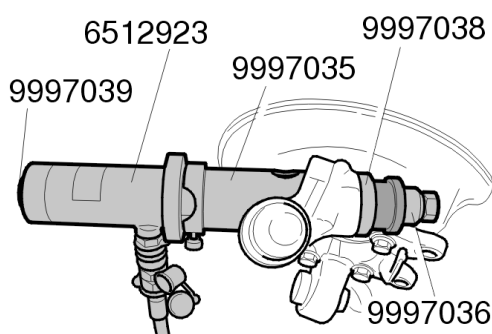

Installing the wheel spindle and tie rod

Install:

- the wheel spindle
- the screw for the lower and upper control

- arm mounting
- the tie rod screw.

Note! Do not tighten the screw for the bushing mountings. This is carried out later when the rear suspension is in the normal position.

Installing the lateral link

Release the tension from the tensioner and allow to hang freely.

Install:

- the retaining strap and secure the lower control arm slightly against the jacking point
- the screw for the lateral link.

Remove the retaining strap.

Tightening the stay and mountings

Press the suspension up to its normal position, see Tensioner, instructions for use .

Tighten:

- both the mountings for the lateral link. Tighten to **80 Nm**
- the outer mounting for the tie rod.

Tighten to

80 Nm

- the control arm mountings.

Tighten to

80 Nm.

Installing the brake cable for the parking brake

- Install the mounting for the cables on the sub-frame and the clips on the tie rods
- Thread the mechanical cables into the brake covers.

Hint:

Lubricate the O-rings on the guide sleeves of the mechanical cables. Use silicone grease.

Note! Ensure that the guide sleeve lug is correctly positioned in the cover.

Hook the expander in the plate bracket.

Install:

- the expander
- the return spring
- the brake disc
- the brake disc locating pin. Tighten to **10 Nm**.

Installing the brake caliper

Install:

- the brake caliper
- the brake caliper mounting screw. Tighten to **60 Nm**. Use new screws
- the ABS sensor
- the screws. Tighten to **10 Nm**
- The ABS sensor cable in the bracket.

Finishing

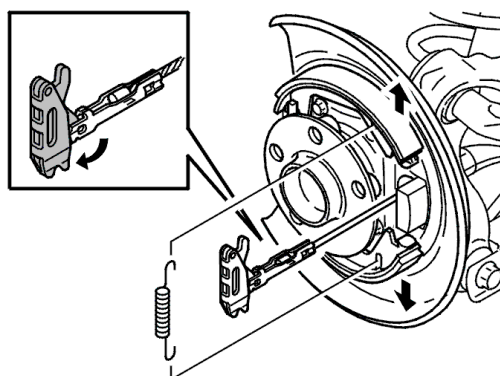
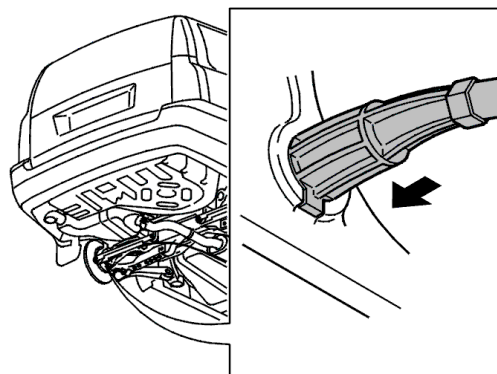

Adjust the parking
brake. See
Handbrake, brake
shoes,
replacing:Adjust the
handbrake .

Install the wheels.
See Installing
wheels .
Check/adjust the
wheel alignment.
See: Wheel
alignment,
checking /
adjusting .

12/11/2015

PRINT